

FST READING

8/26/08

2ND READING

9-2-08

INDEX NO.

MR-2008-092

Edward E. Stephens

ORDINANCE NO. 12156

AN ORDINANCE CLOSING AND ABANDONING A PORTION OF SEWER LINE AND EASEMENT #672, BETWEEN MANHOLES #2 AND #4, LOCATED IN THE 4400 BLOCK OF PINNACLE LANE, MORE PARTICULARLY DESCRIBED HEREIN AND AS SHOWN ON THE MAP AND DRAWING ATTACHED HERETO AND MADE A PART HEREOF BY REFERENCE, SUBJECT TO CERTAIN CONDITIONS.

SECTION 1. BE IT ORDAINED BY THE CITY COUNCIL OF THE CITY OF CHATTANOOGA, TENNESSEE, That there be and is hereby closed and abandoned a portion of Sewer Line and Easement #672, between manholes #2 and #4, located in the 4400 block of Pinnacle Lane, more particularly described below and as shown on the map and drawing attached hereto and made a part hereof by reference:

Abandonment of a portion of sewer line and easement #672 between manholes #2 and #4 located within Tax Map 119G-A-002.02 as shown in the Sanitary Sewer Plan and Profile of the Pinnacle Lane Mini-Warehouses Project, Sheet C-4 drawn by Copp Engineering with revisions on 02/11/08 and 02/19/08. Tax Map 119G-A-002.02.

SECTION 2. BE IT FURTHER ORDAINED, That this abandonment shall be subject to suitable replacement sewer line and easement that meets City Standards and Code.

SECTION 3. BE IT FURTHER ORDAINED, That this Ordinance shall take effect two (2) weeks from and after its passage.

PASSED on Second and Final Reading

September 2, 2008.



VICE CHAIRPERSON

APPROVED: X DISAPPROVED: _____

DATE: 9/8 , 2008

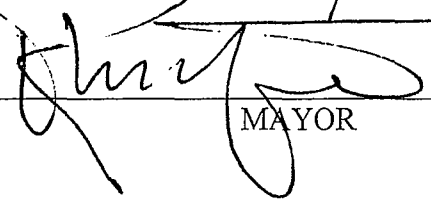

MAYOR

/add

PLANNING AGENCY



CHATTANOOGA
CASE NO: 2008-0092
PC MEETING DATE: 5/12/2008
MR: ABANDON SEWER EASEMENT

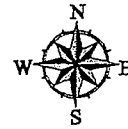

1 in. = 200.0 feet

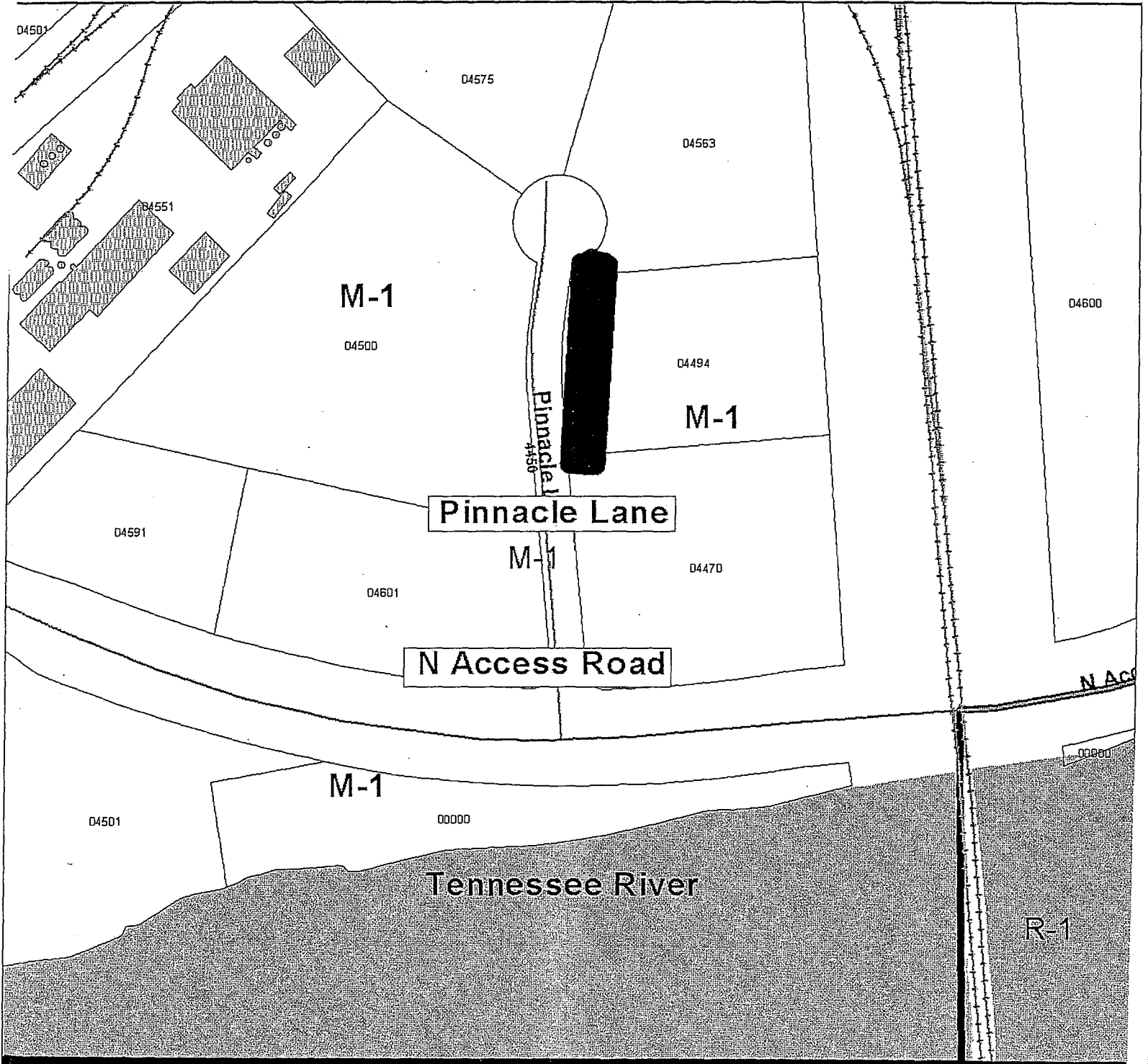
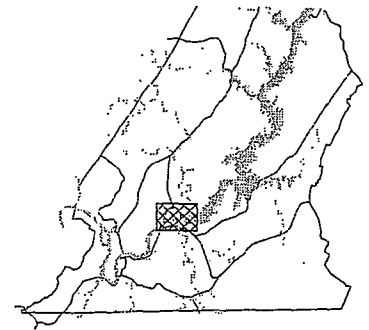

PLANNING COMMISSION RECOMMENDATION FOR CASE NO. 2008-092: Approve, subject to approval of City Engineer and all public utilities.

Cap	Averg	Max	Pipe	Upper	Lower	Sewer	Full	Full
erved	Flow	Flow	Dia	Inv	Inv	Grade	Flow	Flow
							Vel	Cap
8	0.0050	0.0198	8	666.28	665.30	0.44	2.98	1.04
8	0.0050	0.0198	8	665.20	664.93	0.44	2.98	1.04
8	0.0050	0.0198	8	664.83	664.61	0.44	2.98	1.04

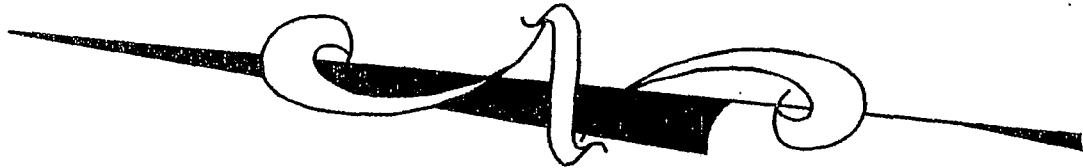

2008-092

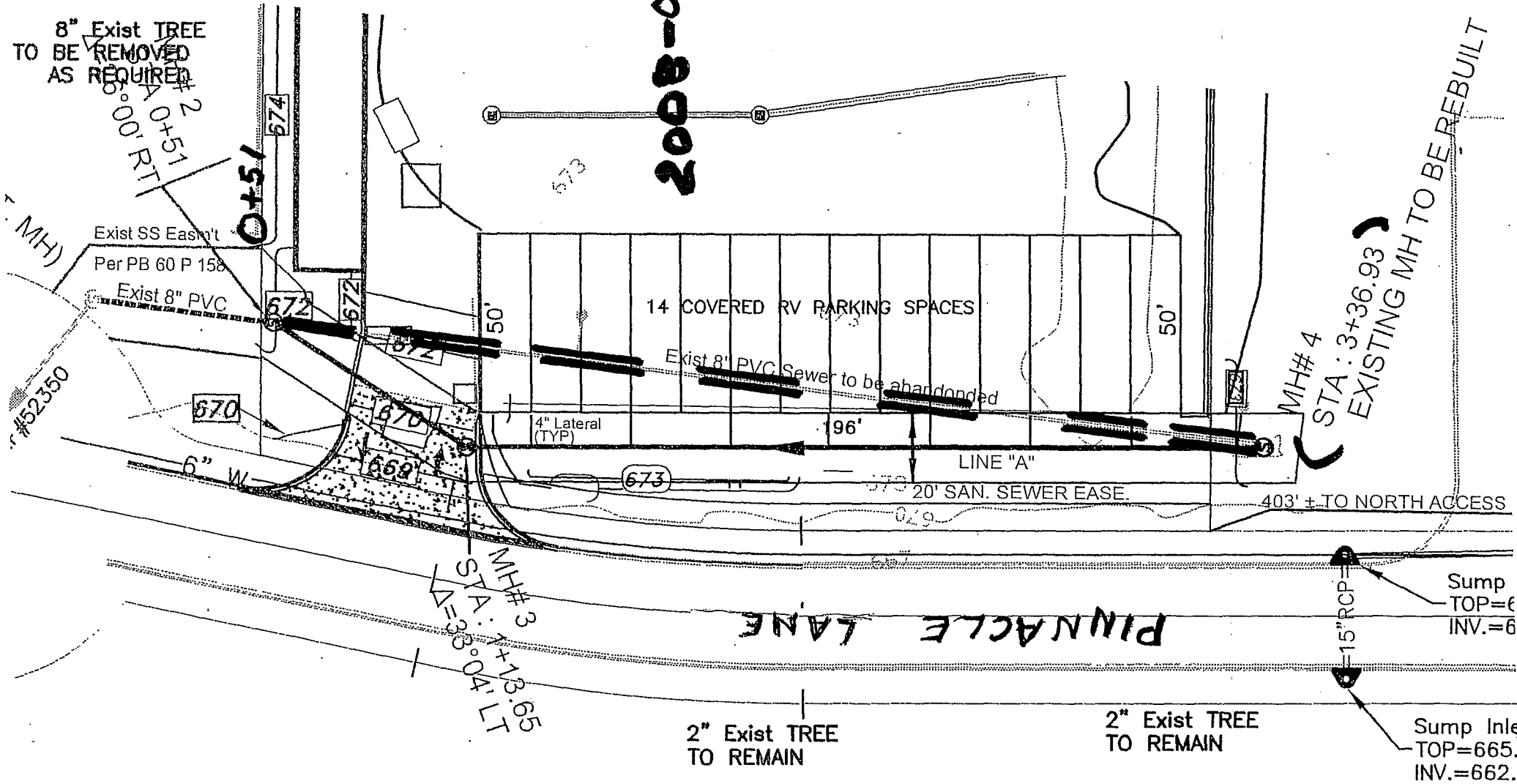

8" Exist TREE TO BE REMOVED AS REQUIRED

MH# 1

#52350

0+51

Exist SS East't Per PB 60 P 158

Exist 8" PVC

14 COVERED RV PARKING SPACES

Exist 8" PVC Sewer to be abandoned

4" Lateral (TYP)

LINE "A"

20' SAN. SEWER EASE.

403' ± TO NORTH ACCESS

MH# 4

STA: 3+36.93

EXISTING MH TO BE REBUILT

MH# 3 STA: 1+04.39

2" Exist TREE TO REMAIN

2" Exist TREE TO REMAIN

Sump TOP=665. INV.=662.

Sump Inle TOP=665. INV.=662.

PINNACLE LANE